



Weatherization Option AYW2 for Outdoor Installation

INSTALLATION FORM RGM 452-WU
New

APPLIES TO:

Model TRP

REZNOR *Thomas & Betts*

Description/Application

A Model TRP ordered with Option AYW2, weatherized unit, is factory-built for installation outdoors. The rainhood for the top of the burner/control box, the rainhood for the door, the vent cap, and the hardware required are shipped separately for installation at the job site. Install the rainhoods prior to suspending the heater; install the vent cap after the unit is suspended.

Parts shipped separately for field installation:

Qty	Description	30	50	60	100
1	Top Rainhood and Gasket Assy	175859	175859	175860	175860
1	Door Rainhood and Gasket Assy	175430	175430	175430	175430
1	Vent Cap, 4"	110051	110051	110051	110051
1	Tube of silicone sealant	--	53335	--	53335
15	Sheetmetal Screws, 10-32 x 1/2" lg	113275	113275	113275	113275

Installation Instructions

- 1. Apply Silicone Sealant (Sizes 50 and 100 only)**
- After adhering tube gaskets and before swinging the turning end up to extend the heater to its full length, apply silicone sealant around the open edge as illustrated in Figure 1.

Figure 1 - Apply silicone sealant to open edge of hinged joint on Sizes 50 and 100

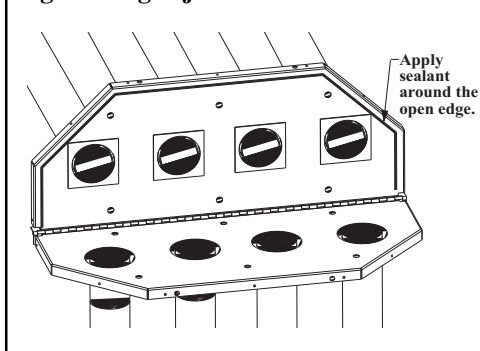

- 2. Install the Top Rainhood (Refer to Figure 2)**
Remove the hanger angle from the burner box. Position the top rainhood and then the hanger angle on the top of the box as illustrated. Attach with sheetmetal screws.
- 3. Install the Door Rainhood (Refer to Figure 2)**
Open the control door.
Position the rainhood assembly over the vents in the door as illustrated. Attach with sheetmetal screws.
Close and latch the door.
- 4. Install the Heater**
Follow the instructions in the heater installation manual (Form RGM 452) to install the heater. Comply with the clearances on page 3 of Form RGM452. **Do not angle mount or install optional side shields on a heater that is installed outdoors.**
A Model TRP installed outdoors must be vented as illustrated in Figure 3.

Figure 2 - Install Top and Door Rainhoods

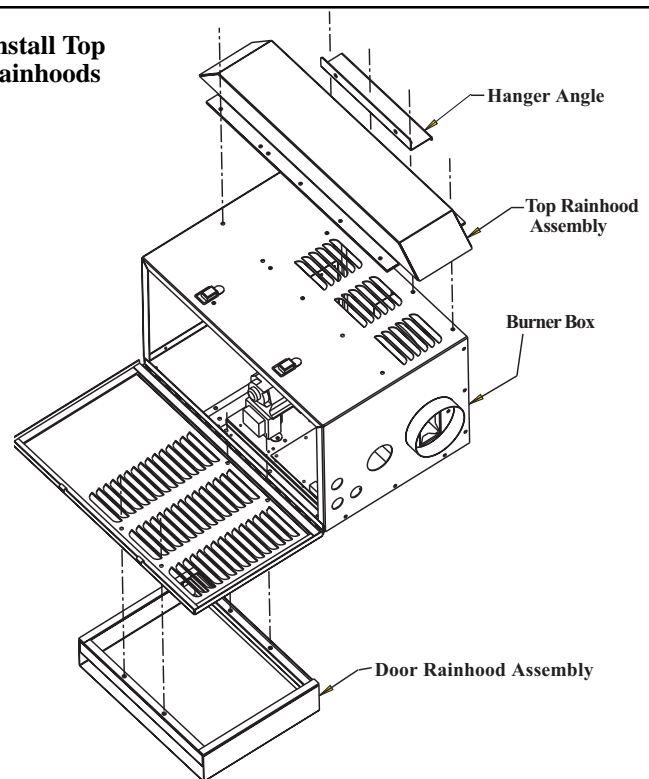

Figure 3 - Vent Arrangement for Outdoor Installation (Model TRP installed outdoors requires weatherization Option AYW2)

Attach horizontal pipe (12" minimum), 90° elbow, and vent cap with three non-corrosive sheetmetal screws (per joint) spaced approximately every 120°. Support vent with non-combustible supports; **do not** rely on the heater for support of the vent.

